

CORNER LOT FENCE REQUIREMENTS:

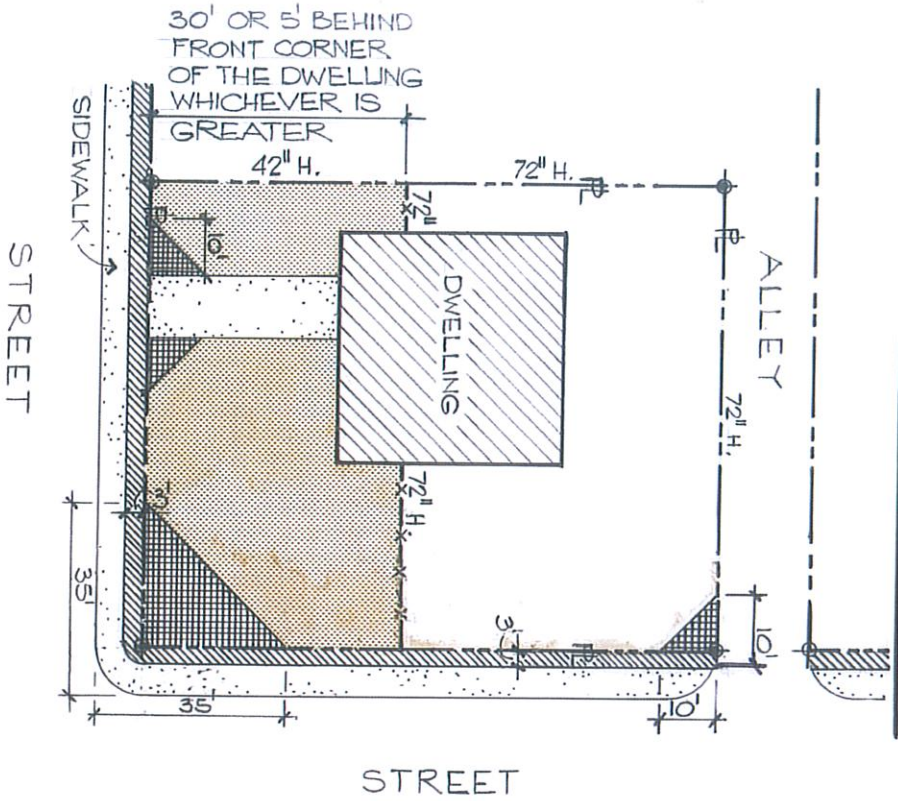

LEGEND :	
	72" HEIGHT MAX.
	42" HEIGHT MAX.
	VISION TRIANGLE, 36" H. MAX.
	NOT PERMITTED ON PUBLIC PROPERTY OR 36" FROM SIDEWALK
	PROPERTY LINE

CITY OF LYNDEN
300 4th Street
BUILDING DEPARTMENT 354-3446
Fence and Accessory Building Requirements

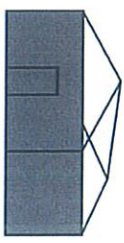

ACCESSORY BUILDING PERMIT REQUIREMENTS IN RESIDENTIAL ZONES LYNDEN MUNICIPAL CODE SECTION 19.15.030 & 060

A building permit is required for any accessory building with 120 square feet or more of floor area (LMC 15.04.010), and for all garages. To apply for a permit you will need to submit two sets of plans, including; a site plan showing setbacks from the cave of the building to the property lines and to the nearest building on the lot, and a plan showing the structural detail of the proposed building. All buildings are required to meet setback requirements, regardless of size or the need for a permit.

Accessory buildings are not permitted in the front yard.

The maximum height for accessory structures is 12 ft, except for detached garages which are allowed a maximum height of 18 ft. Building height is measured from grade to the highest elevation of the roof. Accessory permitted uses include the following:

1. Private garages - No detached garage or accessory building shall exceed 1,000 square feet of inside floor area or 10 percent of the lot area, whichever is greater; provided however, that the floor area of the accessory building does not exceed the floor area of the primary residence or 3,000 square feet, whichever is more restrictive.